

Stainless Steel EN 1092-1 TYPE 01B Slip on PN16 Flange

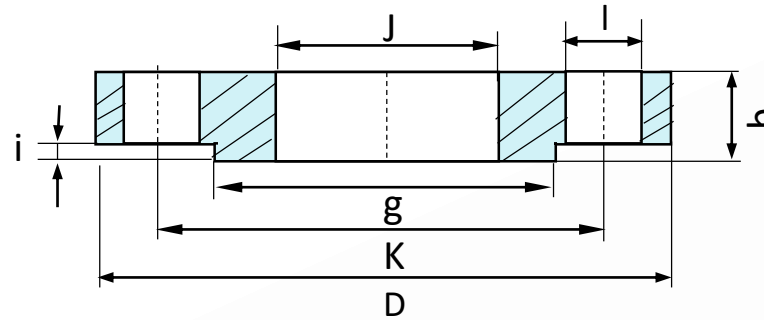

Pipe											
Nominal size in	O.D.	J	k	D	i	b	g	I	Thread	No. of holes	Weight (kg)
0.50	21.30	22.0	65.0	95.0	2.00	14.0	45.0	14.0	M12	4	0.59
0.75	26.90	27.5	75.0	105.0	2.00	16.0	58.0	14.0	M12	4	0.85
1	33.70	34.5	85.0	115.0	2.00	16.0	68.0	14.0	M12	4	1.01
1.25	42.40	43.5	100.0	140.0	2.00	18.0	78.0	18.0	M16	4	1.67
1.50	48.30	49.5	110.0	150.0	3.00	18.0	88.0	18.0	M16	4	1.83
2	60.30	61.5	125.0	165.0	3.00	20.0	102.0	18.0	M16	4	2.44
2.50	73.03	74.5	145.0	185.0	3.00	20.0	122.0	18.0	M16	4	2.99
3	88.90	90.5	160.0	200.0	3.00	20.0	138.0	18.0	M16	8	3.26
4	114.30	116.0	180.0	220.0	3.00	22.0	158.0	18.0	M16	8	4.00
5	141.30	143.0	210.0	250.0	3.00	22.0	188.0	18.0	M16	8	4.95
6	168.30	170.5	240.0	285.0	3.00	24.0	212.0	22.0	M20	8	6.54
8	219.10	221.5	295.0	340.0	3.00	26.0	268.0	22.0	M20	12	9.03
10	273.00	276.5	355.0	405.0	3.00	29.0	320.0	26.0	M24	12	13.21
12	323.90	327.5	410.0	460.0	4.00	32.0	378.0	26.0	M24	12	17.49
14	355.60	359.0	470.0	520.0	4.00	35.0	438.0	26.0	M24	16	26.53
16	406.40	411.0	525.0	580.0	4.00	38.0	490.0	30.0	M27	16	33.83
20	508.00	513.5	650.0	715.0	4.00	46.0	610.0	33.0	M30	20	61.83